



* All images in this datasheet are for illustrative purposes only.

UHD Signage UL3J-E

LG webOS UHD Signage



Superb Picture Quality with Ultra HD Resolution



Sophisticated Slim Design



High-Performance with webOS 6.0



Various Sensor Connection



Compatible with **LG One:Quick** Share



Compatible with AV Control Systems

UL3J-E

Inch	75" / 65" / 55" / 50" / 43"
Screen Resolution	3,840 × 2,160 (UHD)
Operation Time	16 Hours / 7 Days
Brightness	75" : 330 nits 65" / 55" / 50" : 400 nits 43" : 300 nits
LG Solution Compatibility	LG One:Quick Share, LG ConnectedCare, LG SuperSign CMS/Control, Promota App*

* Not available for Europe/CIS Region

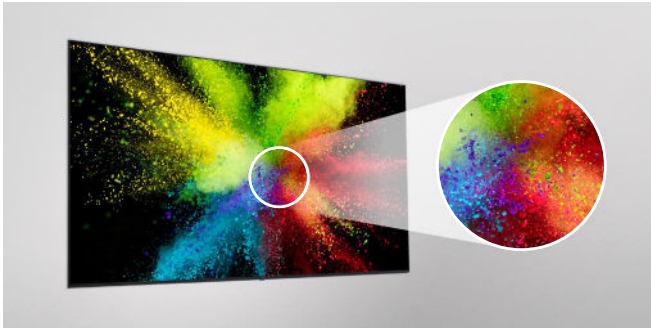

Superb Picture Quality with Ultra HD Resolution

With the resolution of UHD, it makes the color and details of the contents vivid and realistic. In addition, the wide viewing angle applied with an IPS panel, provides clear contents.

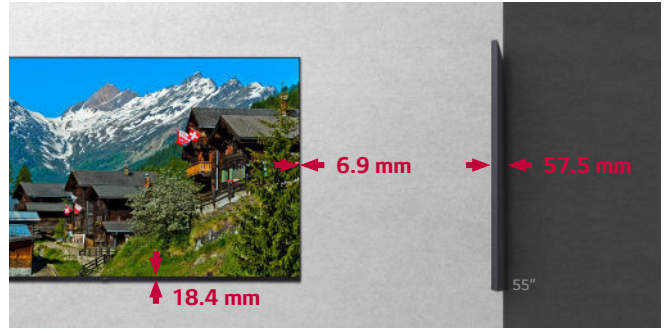

Sophisticated Slim Design

This series is thin in bezel size and thickness*, which saves space and enables easy installation. In addition, it increases the immersive experience from the screen and provides a sophisticated design, improving the décor of the space where the product is installed.

* Compared to LG's UL3G series



High-Performance with LG webOS 6.0

LG webOS 6.0, upgraded in SoC* and web engine, is available on UL3J series for a smooth execution of several tasks. LG webOS smart signage platform enhances user convenience with intuitive GUI.**

* SoC : System On Chip
 ** GUI : Graphical User Interface



Compatible with Video Conference System

For effective visual meeting, the UL3J series supports its compatibility with Cisco solutions that offers powerful and integrated control* for a smarter video conference.

* Using an HDMI cable connection (HDMI cable is optional)

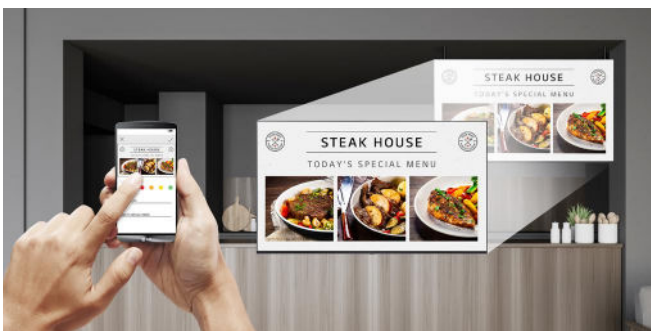

LG's Simple Advertisement Helper, Promota

Using LG's Promota* application, downloadable on a mobile device, you can easily create your own display contents. With Promota, you can add text and images to create an online profile for your business as well as deliver information such as event news, seasonal menus, promotions, and even more to your customers while recommending easy-to-use templates relevant to your industry.

* LG Promota is can be downloaded from the App Store and Google Play store. (Not available for Europe/CIS Region)

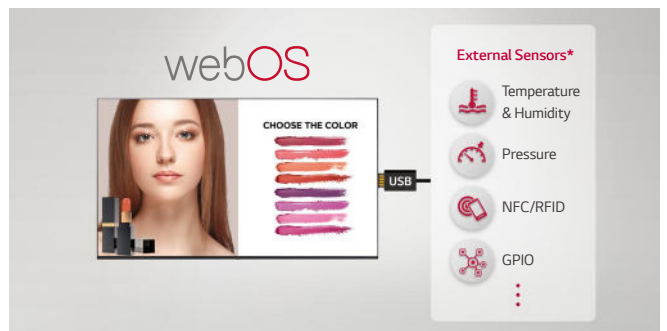

Various Sensor Connection

LG webOS smart signage platform helps to easily provide value-added solutions* by supporting simple connections with external sensors** such as GPIO, NFC/RFID, temperature sensors, etc., via USB plug-in.

* e.g. showing specific promotional information according to weather change to store visitors

** External sensors need to be purchased separately and tested for compatibility with webOS platform.

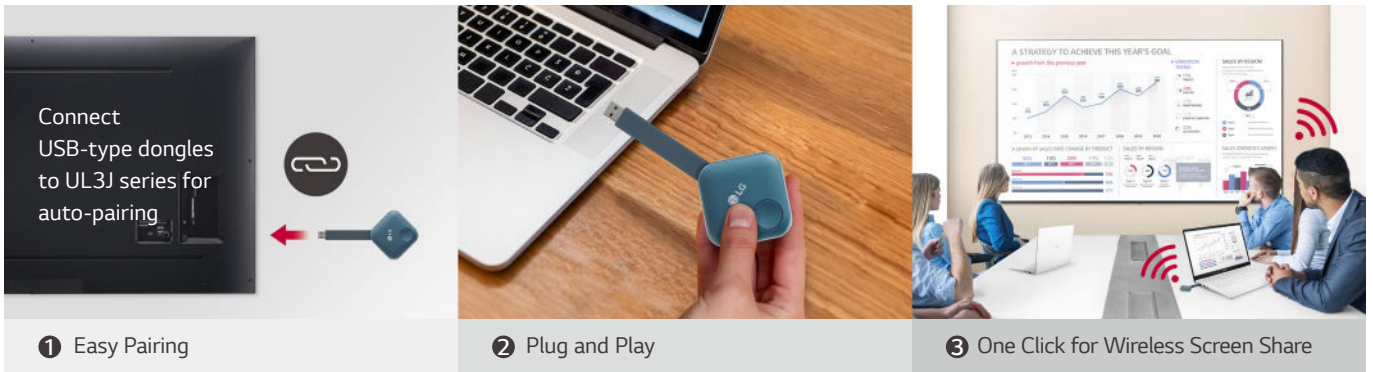

LG's Wireless Screen Sharing Solution, LG One:Quick^{Share}

LG One:Quick Share is a wireless screen sharing solution available through the UL3J series, USB transmission unit, and its app. You can simply share personal PC screen to the display with it's USB dongle button and embedded Wi-Fi*, and can adjust the basic setting values (volume, picture mode, auto bright, etc.) of the connected display without a remote control. Also, the Office Meeting Mode** helps you to display the agenda, note before the meeting starts.

- * Users need to set up Soft AP enabled at Network Menu of the Signage.
- ** Users can enable Office Meeting Mode at EZ Setting Menu of the Signage.
- *** LG One:Quick Share needs to be purchased separately.

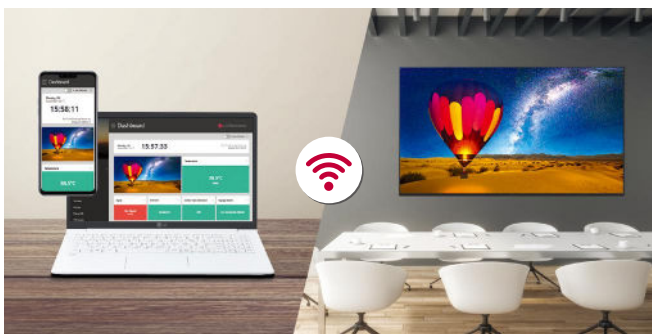

Remote Monitoring and Control

This web-based monitoring solution is user-friendly and allows the user to be at ease. It enables the user to have full access anywhere at anytime from their mobile phone & PC under network-accessible environment while having access to both current and past data. It allows the user to monitor the unit, make adjustments and control the unit remotely in real time.

Compatible with AV Control Systems

The UL3J series supports Crestron Connected®** for high compatibility with professional AV controls to achieve seamless integration and automated control**, boosting business management efficiency.

- * Initial setting from display is required for Crestron Connected® compatibility.
- ** Network based control

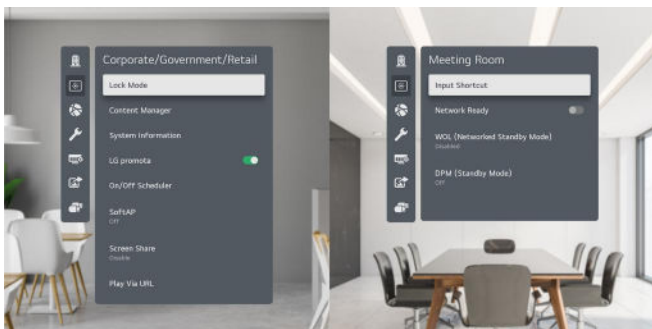

Easy Menu Setup for Vertical Needs

UL3J series increases users' convenience by organizing frequently used menus* by industry.

Built-in Speaker

Contents will be enriched with sound effects from built-in speakers, without the need for purchasing or installing external speakers.

* Pre-set Support Vertical : Corporate / Government / Retail, Meeting room

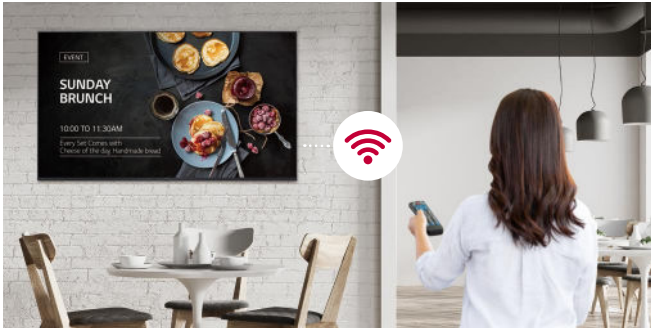

Easy Content Distribution & SW Update

UL3J series features embedded Wi-Fi making it easy to distribute content wirelessly and update Firmware under the same network.



Wireless Access Point

UL3J series operates as a virtual router which can be an wireless access point for mobile devices.



Real-time LG ConnectedCare Service

Maintenance is easy and fast with the optional LG ConnectedCare* service, a cloud service solution provided by LG. It remotely manages the status of displays in client workplaces for fault diagnosis and remote-control services, supporting the stable operation of clients' businesses.

* The availability of the 'LG ConnectedCare' service differs by region, and it needs to be purchased separately. So please contact the LG sales representative in your region for more details.



EPEAT Registered

The Electronic Product Environmental Assessment Tool (EPEAT) is a method for several layers of customers to evaluate the effect of a product on the environment. UL3J is EPEAT Bronze-certified* display which means that it meets all the required criteria in Computers and Displays category.

* Registered on April, 2021

CONNECTIVITY

75" / 65" / 55" / 50" / 43"

Rear

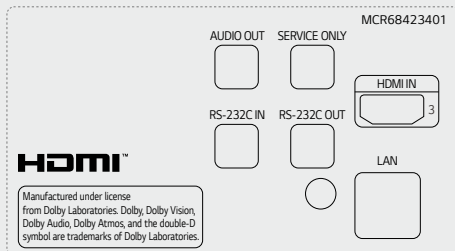

Side

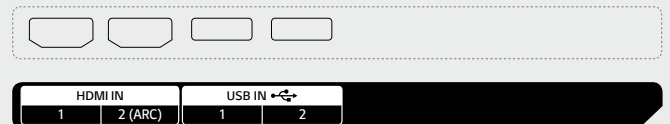

* Jack Panels may differ from the above image, so please contact LG sales team to verify before ordering.



Download
LG C-Display+
Mobile App
Google Play Store

- www.lg.com/global/business/information-display
- www.youtube.com/c/LGCommercialDisplay
- www.facebook.com/LGInformationDisplay
- www.linkedin.com/company/LGInformationDisplay
- twitter.com/LG_ID_HQ

LG may make changes to specifications and product descriptions without notice. Copyright © 2021 LG Electronics Inc. All rights reserved. "LG Life's Good" is a registered trademark of LG Corp. The names of products and brands mentioned here may be the trademarks of their respective owners.

